

# WOODHAVEN

## BEFORE BEGINNING

Identify and verify that you have all the parts listed. Read the instructions at least once, familiarizing yourself with the parts and assembly instructions before beginning. You'll need a #3 Phillips screwdriver for assembly. You'll use the new hardware, as well as some of the existing hardware from your 966 Biscuit Master.

## DISASSEMBLY

Remove the 6" fences (4006) from the Fence Brackets (966C) and remove the Fence Brackets from the MDF Base (966B). Save the hardware you remove as you will use some of it for the Assembly. *See fig. 1.*

## ASSEMBLY

Install the 1-1/2" screws (MF025) thru the countersunk holes in the MDF Base (966B) and install the Domino Guides (966E1) over the screws as shown. Start two oval nuts (5760B) on the two screws closest to the edges of the MDF Base and start an offset oval nut (5765B) on the remaining two screws, with the wide side of this oval nut facing the other oval nut as shown. Align the end and edge of the Fence Bracket with the two edges of the "L" cutout in the Domino Guide and tighten the screws. *See fig. 2.*

# 966D Domino Kit

*Please Read Carefully!*

## Parts List:

Part	Description	Quantity
966E1	Domino Guide.....	1 pair
966E2	Domino Fence.....	1 pair
5765B	Offset Oval Nut.....	2
5760B	Oval Nut.....	2
MF025	1-1/2" Screw.....	4
5771B	3/4" Screw.....	2

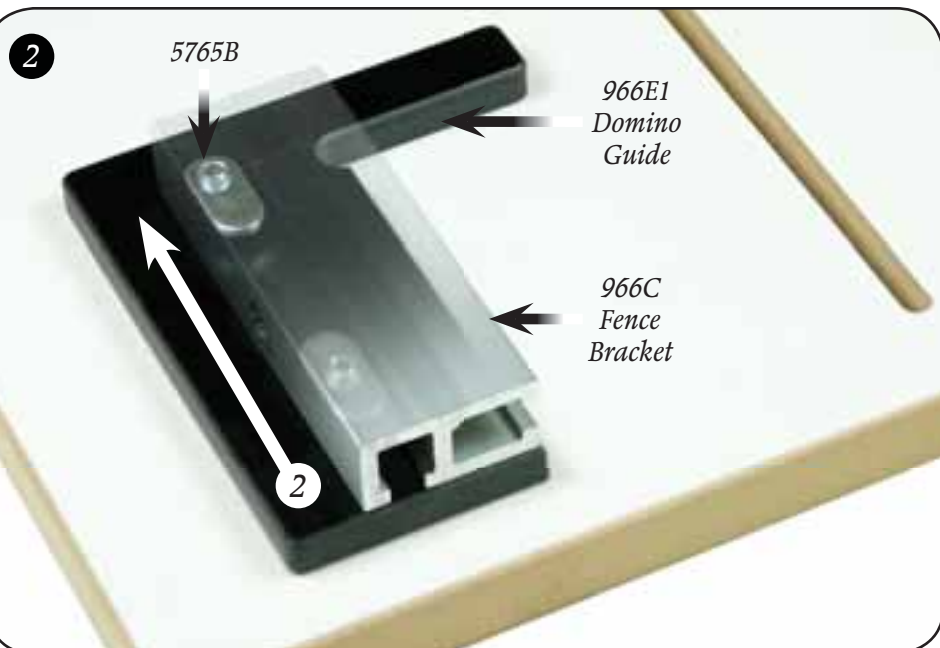
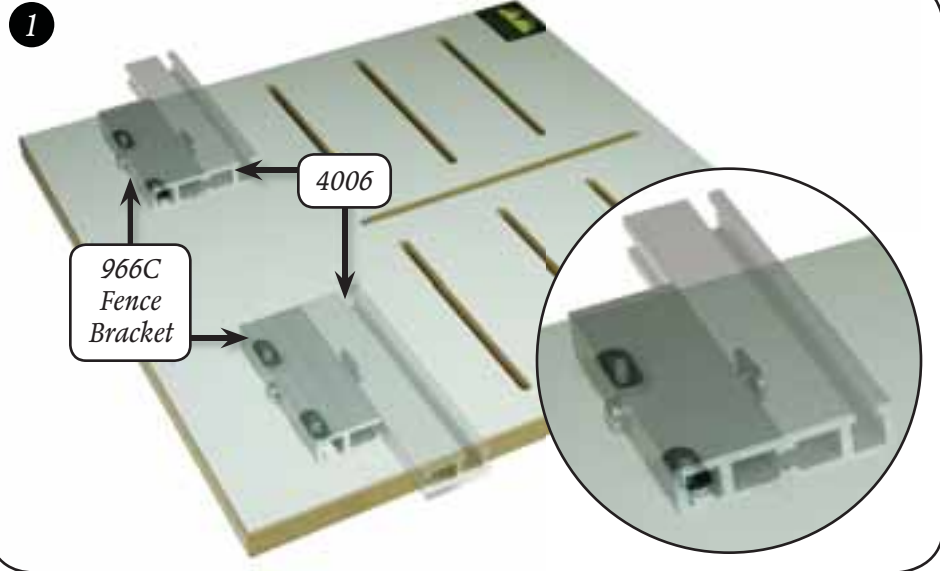

Install the existing 1" screws (*MF015*) you removed from the MDF Base earlier, insert them thru the countersunk holes in the Domino Fence (*966E2*) and start existing oval nuts (*5760B*) on the ends of the screws. Slide the Domino Fence on to the T-slot in the front of the Fence Bracket until it butts against the "L" cutout in the Domino Guide and tighten the screws. *See fig. 3.*

Install an existing washer (*WB002*) on the 3/4" screw (*5771B*), insert the screw thru the hole in the Domino Fence and start an oval nut on the end of the screw. Slide the 6" fence (*4006*) on to each oval nut until it butts against the "L" cutout in the Domino Guide and tighten the screw. *See fig. 3.*

Clamp the MDF Base to a bench so it overhangs enough to provide access to the four screws in the underside. Loosen the four screws, place your Domino machine between the Domino Guides and clamp a straight edge to both 6" fences. Lightly squeeze the two Domino Guides together (with the Domino machine between them) and tighten the screws.

Follow the directions that came with your 966 Biscuit Master as far as how to use this.

©Copyright WOODHAVEN INC. 9/15/07  
(800) 344-6657 or WWW.WOODHAVEN.COM

